

FLYNN



FLYNN SPACE

Technical Information Packet
2020

Contents

General Information	3
Theatre Specifications	4
Soft Goods	4
Lighting	4
Sound	5
Video	5
Assisted Listening	5
Dressing Rooms / Performer Support	5
Burlington Map / Directions	6
 Theatre Floor Plan	 7
 Seating Configurations:	
Wide	8
Wide With Stage	9
Cabaret East	10
Thrust	11
In The Round	12
Jazz North	13
 Technical Plans	
Grid Plan	14
Circuit Plan	15
 Photos: Wide With Stage / Cafe/Bar	 16



Jazz Configuration

General Information

- Located at 153 Main Street in downtown Burlington, FlynnSpace is a flexible black-box performance venue downstairs at the Flynn Center for the Performing Arts. Please see page 6 for directions and local map.
- Our seating capacity ranges from 89 to 180 depending on the configuration. The total maximum occupancy is 200 and must include all performers, staff and crew. See attached plans for details as well as seating totals for each configuration. These represent a sample of the configurations possible. **Please note:** seating totals for each configuration vary depending on performance space needs, sightlines, and fire egress codes. Please contact the Technical Director to obtain a plan of the configuration that is going to be in place leading up to your event, and to discuss capacity options. Configuration changes may require additional rental days and fees, as it takes our union crew a full day to reconfigure the space as well as the associated lighting, sound, rep plots.
- Our main loading access is via the front entrance (147 Main Street) where stairs or a small elevator is available to transport equipment to the basement level where FlynnSpace is located. The back entrance is located behind Flynn Center (off King Street) where you will find a loading dock with stairs leading down to the space. This access requires a Flynn staff member to gain access.
- The Flynn Center operates under a contract with I.A.T.S.E. Local #919 regarding stage labor to be employed in the space. To insure arrangements can be made to meet your labor needs scheduling of crew should be planned well in advance.

***PLEASE NOTE: THE FLYNN CENTER IS A SMOKE FREE ENVIRONMENT
SMOKING IS NOT PERMITTED ANYWHERE IN THE BUILDING.***

Contact Information

FlynnSpace Manager / Technical Director	Stefan Jacobs	802.652.4561 sjacobs@flynncenter.org
Production-Stage Manager	Saskia Giramma	802.652.4550 sgiramma@flynncenter.org

Director of Programming	Steve MacQueen	802.652.4503 smacqueen@flynncenter.org
Associate Director of Programming	Madeline Bell	802.652.4540 mbell@flynncenter.org
Rentals and Front of House Manager	Kyla Waldron	802.652.4519 kwaldron@flynncenter.org
Artist Services Coordinator	S. Parker	802.652.4576 sparker@flynncenter.org
Director of Box Office Operations	AJ Fucile	802.652.4536 AJFucile@flynncenter.org

Theatre Specifications

Facility Dimensions:

- Room size: 44' x 54'
- Ceiling height: 7' 10" / 9' 4" / 10' 0"
- Unistrut & Pipe Grid Height: 9' 2" to 9' 10"
- Electrical Raceway Height: 9' 0"
- Elevator Dimensions: 69 W x 51" D x 87" H. The door measures 3' x 7'
- Tech Table includes lighting, sound, and video. Location vary depending on configuration

Soft Goods

- North, East, and West walls outfitted with black curtains on track with carriers
- Inventory of black velour curtains for masking as needed
- 2- 20' moveable sections of curtain track with carriers
- White Sharkstooth Scrim 9' high x 40' wide, with pipe pocket
- Black Sharkstooth Scrim 9' high x 40' wide, with pipe pocket
- White Cyclorama 9' high x 40' wide

Lighting

Console / Dimming

- ETC Element-2 console 1,024, with ETC Nomad 512 Dongle, Gadget-2 Interface, and iPad Control
- 57 Available Dimmers consisting of the following:
 - 48 ETC sensor 2.4k dimmers (includes 3 house light dimmers) - 45 available
 - 3 ETC Smart Module 4 x 600w dimmer packs - 12 available
- 24 permanently mounted 150w house/work lights controlled from console or wall controls

Instruments / Hardware

- 30 ETC Source Four Junior Zooms, 575w (takes M size gobos)
- 10 ETC Source Four Pars 575w XWFL (WFL, MFL NSP, VNSP lenses available)
- 30 6" Fresnels, 500w
- 2 Source Four 26 degree equipped with Rosco I-Cue and Rosco DMX Iris
- 2 ChromaQ 6' Color Force I strip lights with "border" wide dispersion lens
- 3 Chroma Q Color Force II 6' strip lights with "cyc" lens
- Assorted cables, twofers, stage pin to Edison adaptors
- Lighting Accessories include: iris, template holders, barn doors, top hats, and donuts
- C-clamps and Unitstrut hardware to hang lighting instruments
- 6 lighting booms with bases
- 8 side arms
- 10 floor plates
- We have a limited color stock in-house - Please send color cut list well in advance

Circuits/Grid

The lighting grid consists of Pipes running East / West, and Unistrut track running North / South. Please see Circuit Plan for circuit locations. All stage circuits are 3 pin stage connectors (2 P&G.)

Fire Code

Due to fire code and fire alarm system there is no live flame, pyro, smoke, or fog allowed. All special effects must be approved in advance by the FlynnSpace Technical Director. All electrical equipment brought into FlynnSpace must meet current electrical codes. All scenic elements must be flameproof and back-painted.

Sound

- Yamaha QL-5 Digital Mixing Console with iPad Control
- 2 Meyers UPJ-1P House Main Speakers
- 6 Meyers UPM-1P Center & Side Fills
- Galileo Galaxy 408 Network Processor (with Meyer Compass and Dante Control Software)
- Yamaha Dante Rio 32 Input 8 Output Digital Stage Rack
- 6 L'Acoustics X8 Monitor Wedges (6 Mixes)
- 2 L'Acoustics SB15 subwoofers
- 3 Galaxy Audio Core PA5X140 Hot Spot Powered Speakers
- Mac Mini (Sierra) with Qlab 4 (16 Outputs)

Microphones:

- | | | |
|----------------------------|----------------------|---------------------------|
| ▪ 1 AKG D112 | ▪ 2 Equitek CAD E100 | ▪ 4 Shure SM58 (Wireless) |
| ▪ 2 AKG C214 | ▪ 2 Sennheiser MD421 | ▪ 6 Shure SM 57 |
| ▪ 1 Altec-Lansing AL 40 ND | ▪ 1 Shure SM 86 | ▪ 1 Shure Beta 52 A |
| ▪ 2 Beyer M 88 | ▪ 6 Shure SM 58 | ▪ 2 Shure SM 81-LC |
| ▪ 2 DPA 4099 | | |

Other:

- Assorted mic cables
- 3 Straight Round Base Mic Stands,
- 10 Tall tripod boom arm mic stands / 4 Short tripod boom arm mic stands
- 12 Chan 50' Sub Snake / 6 Chan 25' Sub Snake
- 7 Passive DI Boxes / 3 Active DI Boxes

Video

- Panasonic PTDZ 780 LBU 7k lumen Projector with short throw lens (Flynn Staff operated only)
- Panasonic PTLB 60U 3K lumen Projector
- Ben Q MW621 ST 3K lumen Projector with short throw lens
- Da-Lite 4:3 (6' x 8') Front/Rear Projection Screen with legs or can be can grid mounted
- Da-Lite 16:9 (6' x 10' 8") Front/Rear Projection Screen with legs or can be can grid mounted
- Gefen 4K Ultra HD Extender over Ethernet
- Roland V1-HD Video Mixer 4 In and 1 Out. Preview monitor

Piano

- Yamaha C7 Grand (Additional rental / tuning charges apply)

Intercom / Monitor

Clear-Com and dressing room monitor system

Assisted Listening

FlynnSpace is equipped with a hearing assist system with headsets available to patrons.

Dressing Rooms & Performer Support

- The Dressing Room consists of two small dressing rooms, green room area, bathroom, and shower. Each dressing room has a sink, make-up mirror with incandescent lighting and a clothing rack.
- The Green Room area includes an equity cot, small refrigerator, spring water, iron, ironing board, and steamer.

Burlington City Map / Directions to Flynn

From I-89 North or South take Exit 14W. The off ramp takes you to Main Street. Continue past the University and down the hill towards downtown Burlington and Lake Champlain. The Flynn Center is on the left past Church Street.

From Vermont Route 7 continue into Burlington and bear left at all forks. Route 7 becomes St. Paul Street. Turn right at the intersection of St. Paul and Main Street. The Flynn is on your right.

For more directions visit <http://www.flynncenter.org/about-us/area-directions-parking.html>

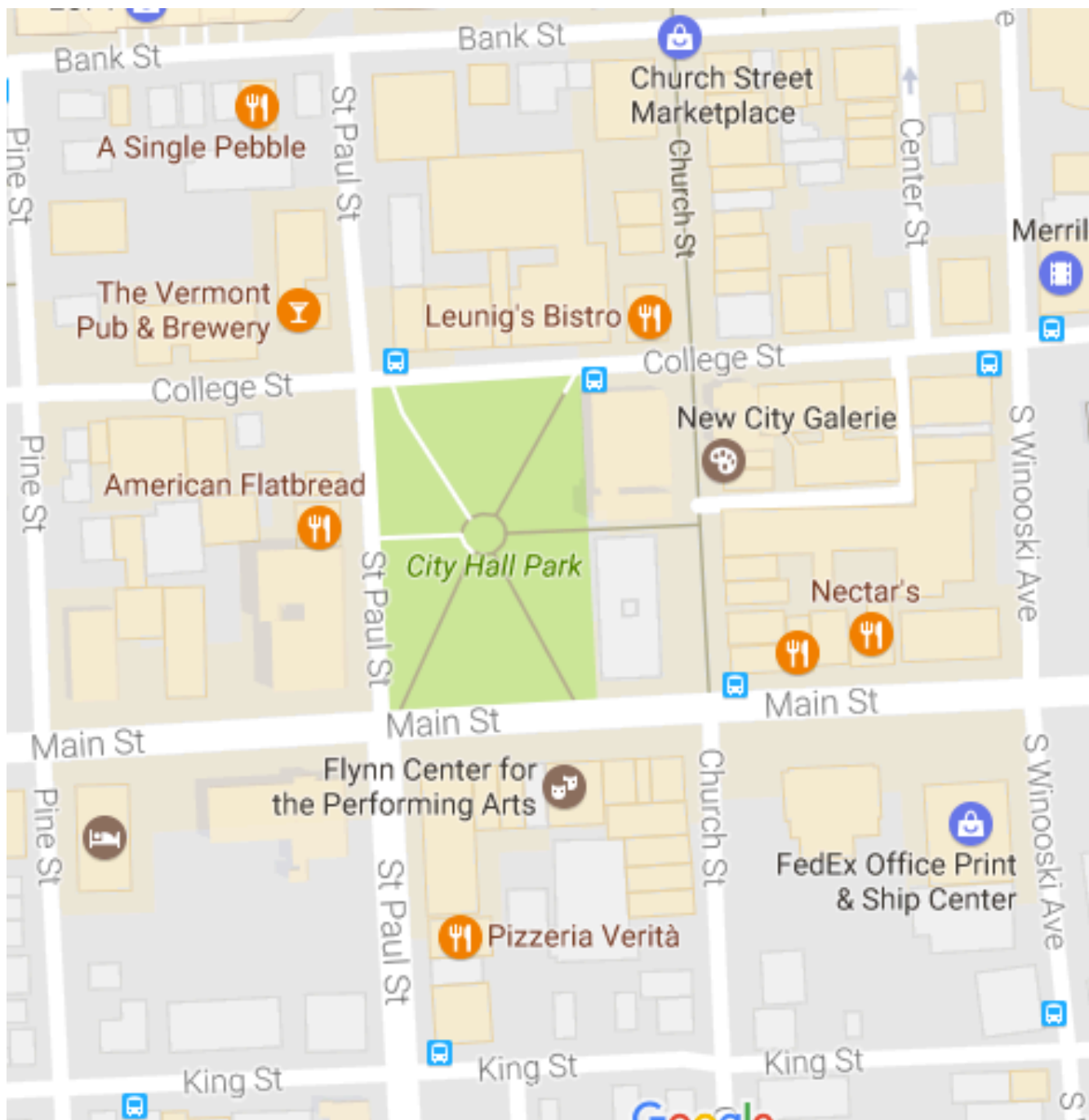

Theatre Floor Plan

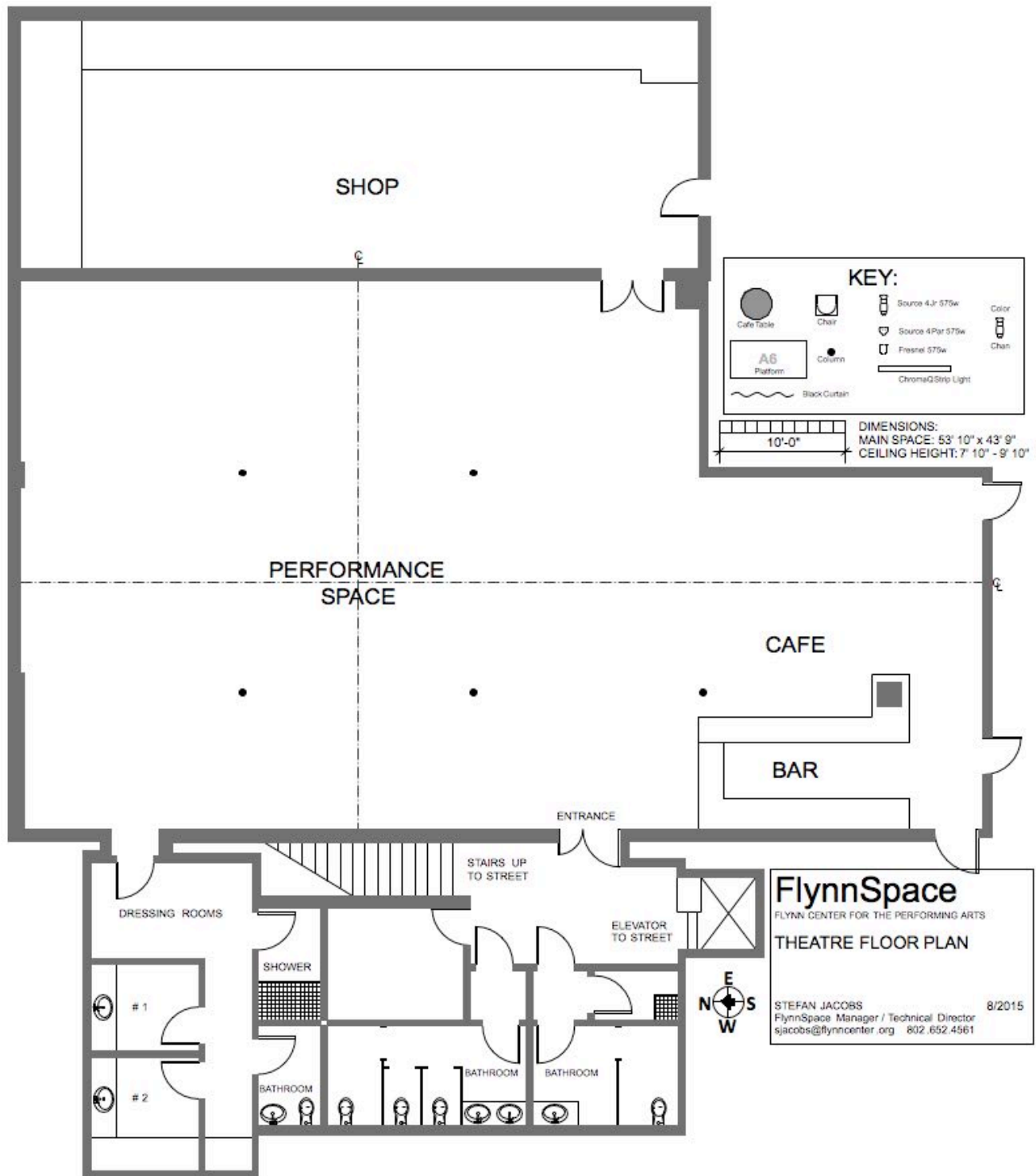

Wide Configuration

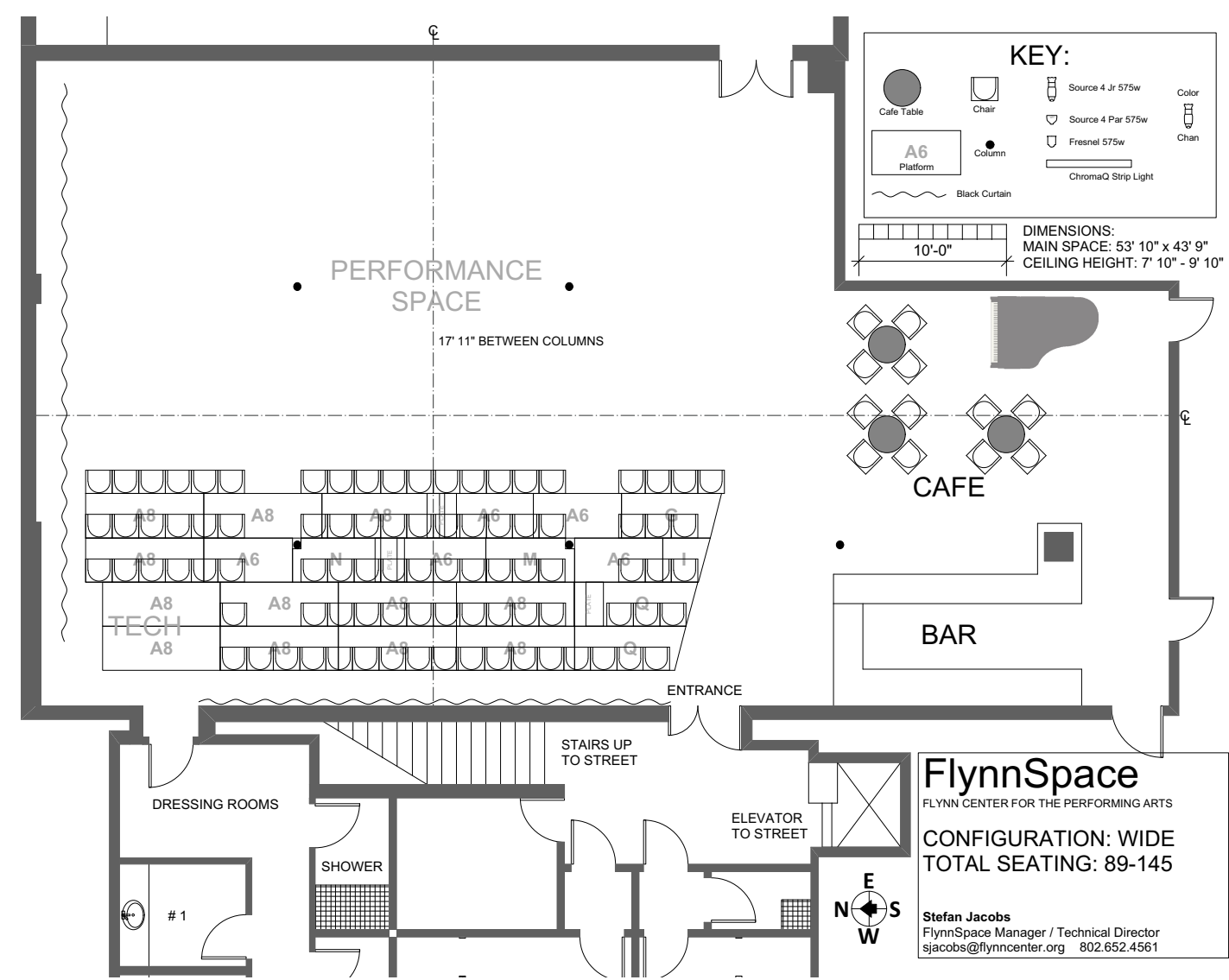

Wide With Stage Configuration

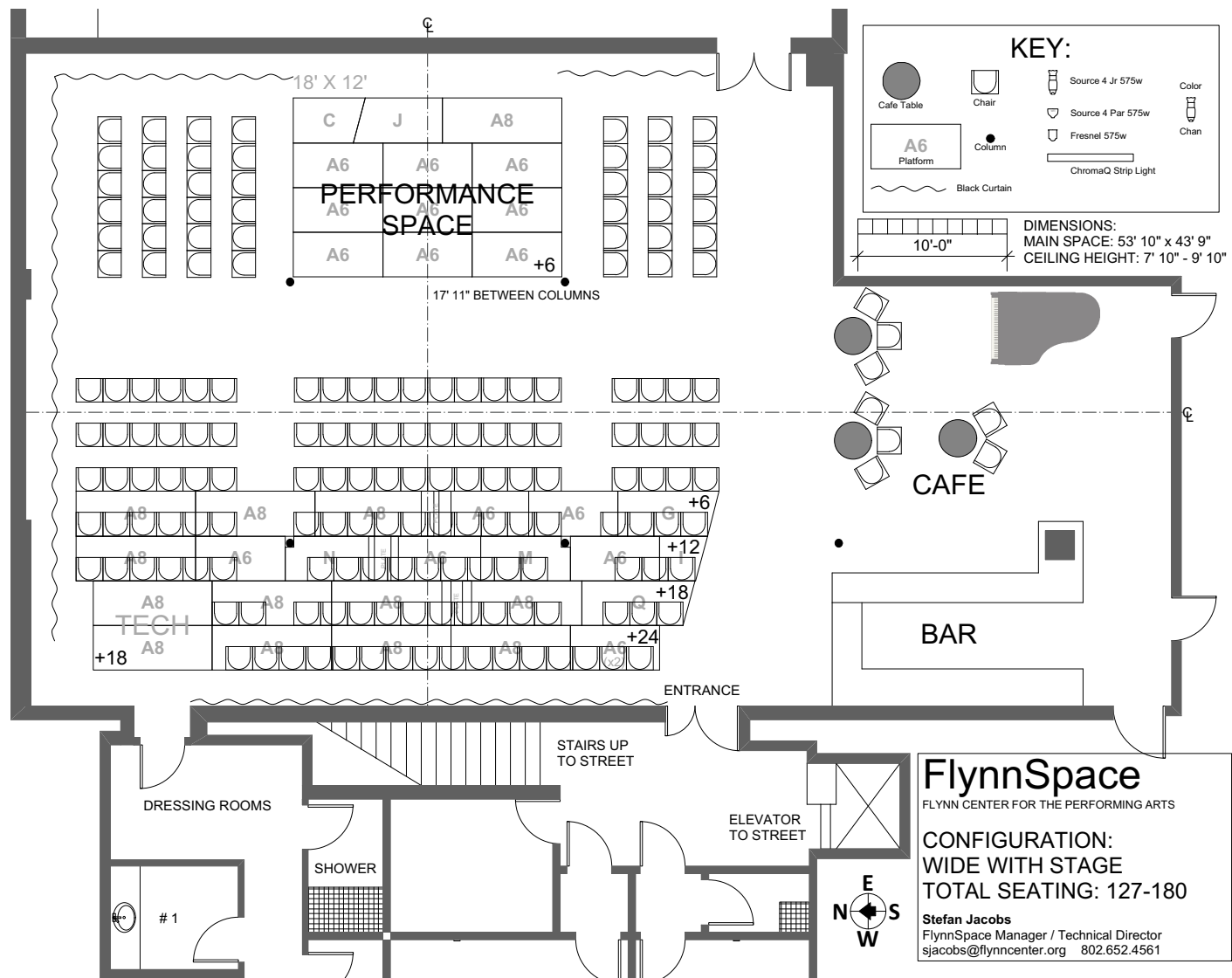

Cabaret East Configuration

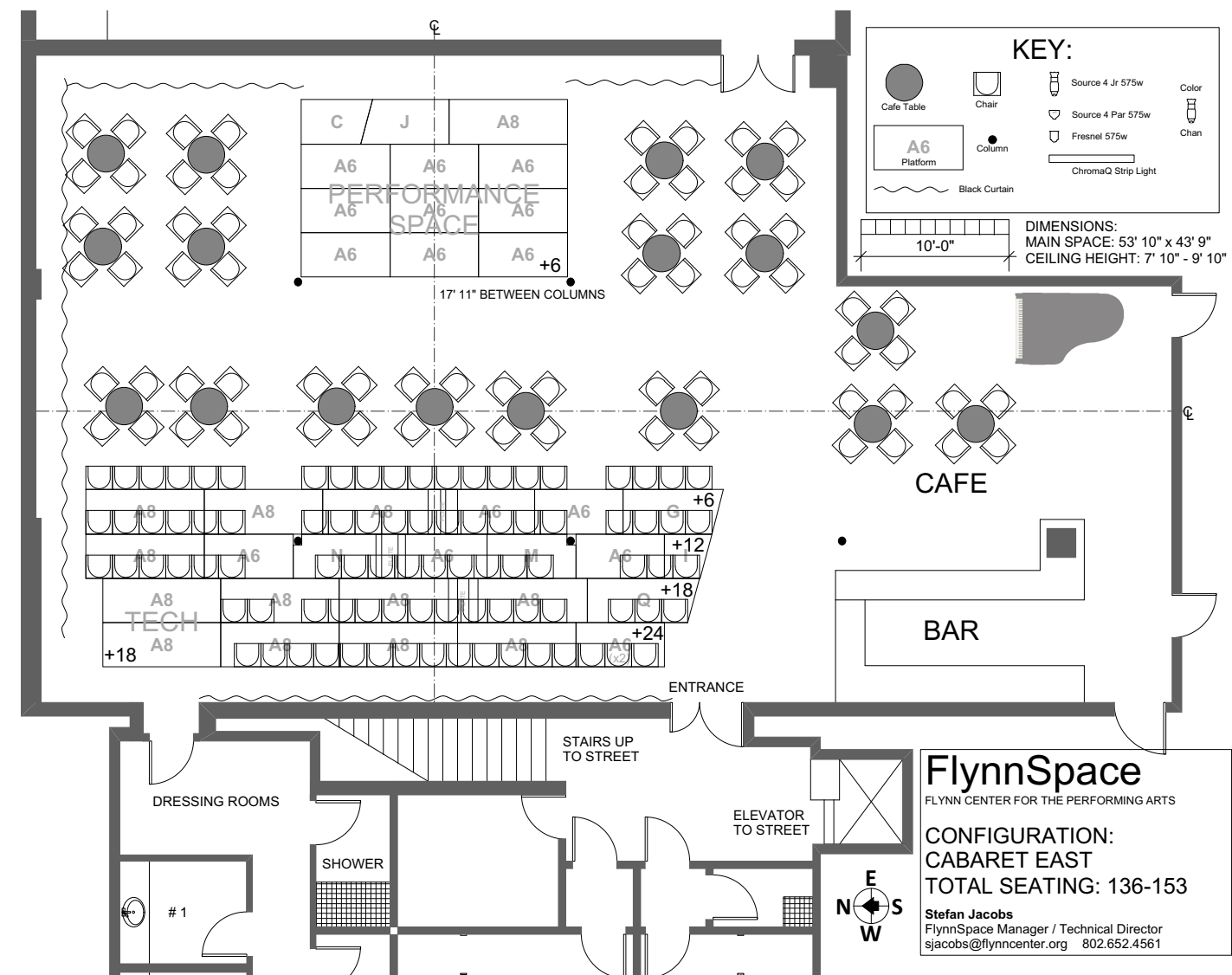

Thrust Configuration

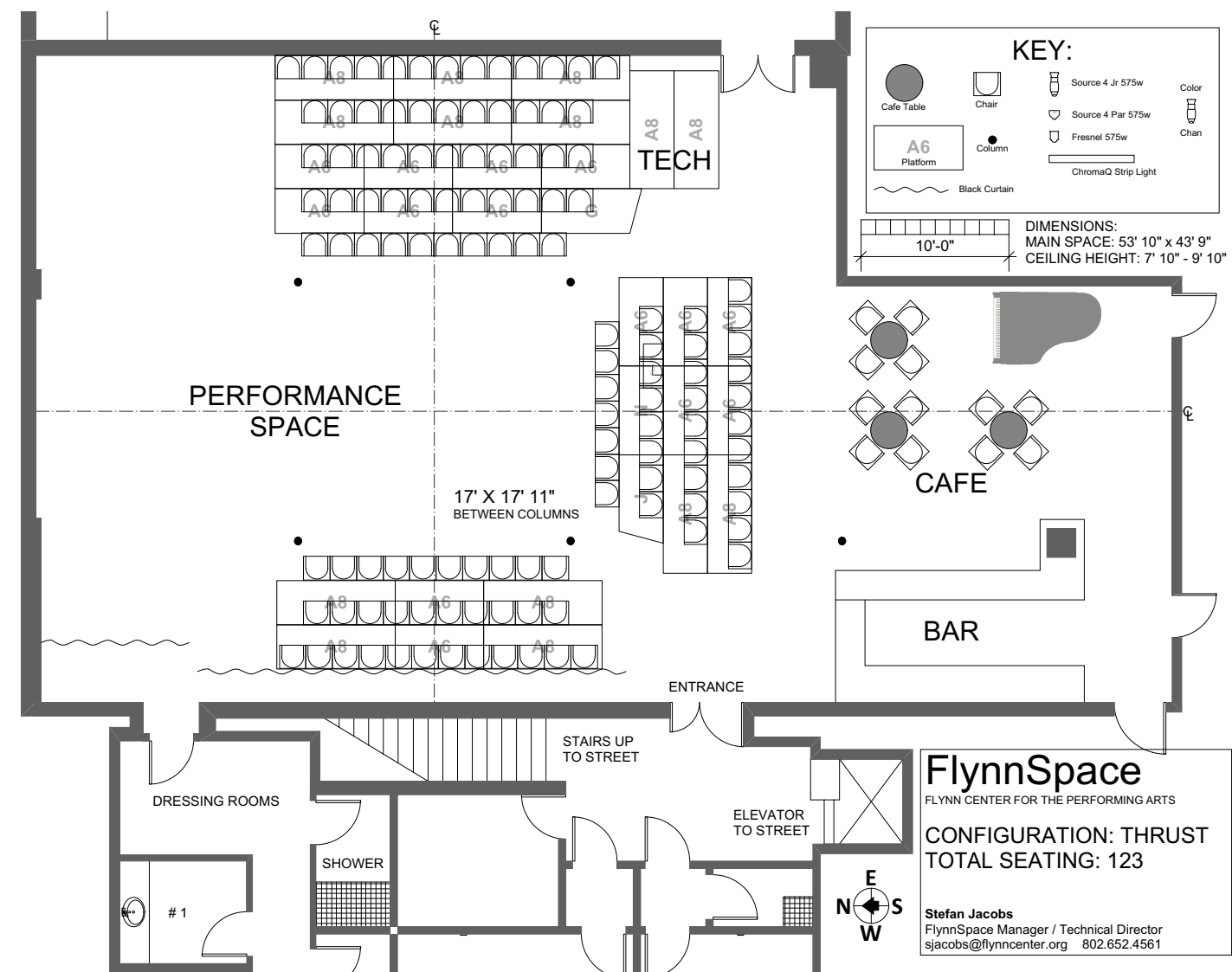

In The Round Configuration

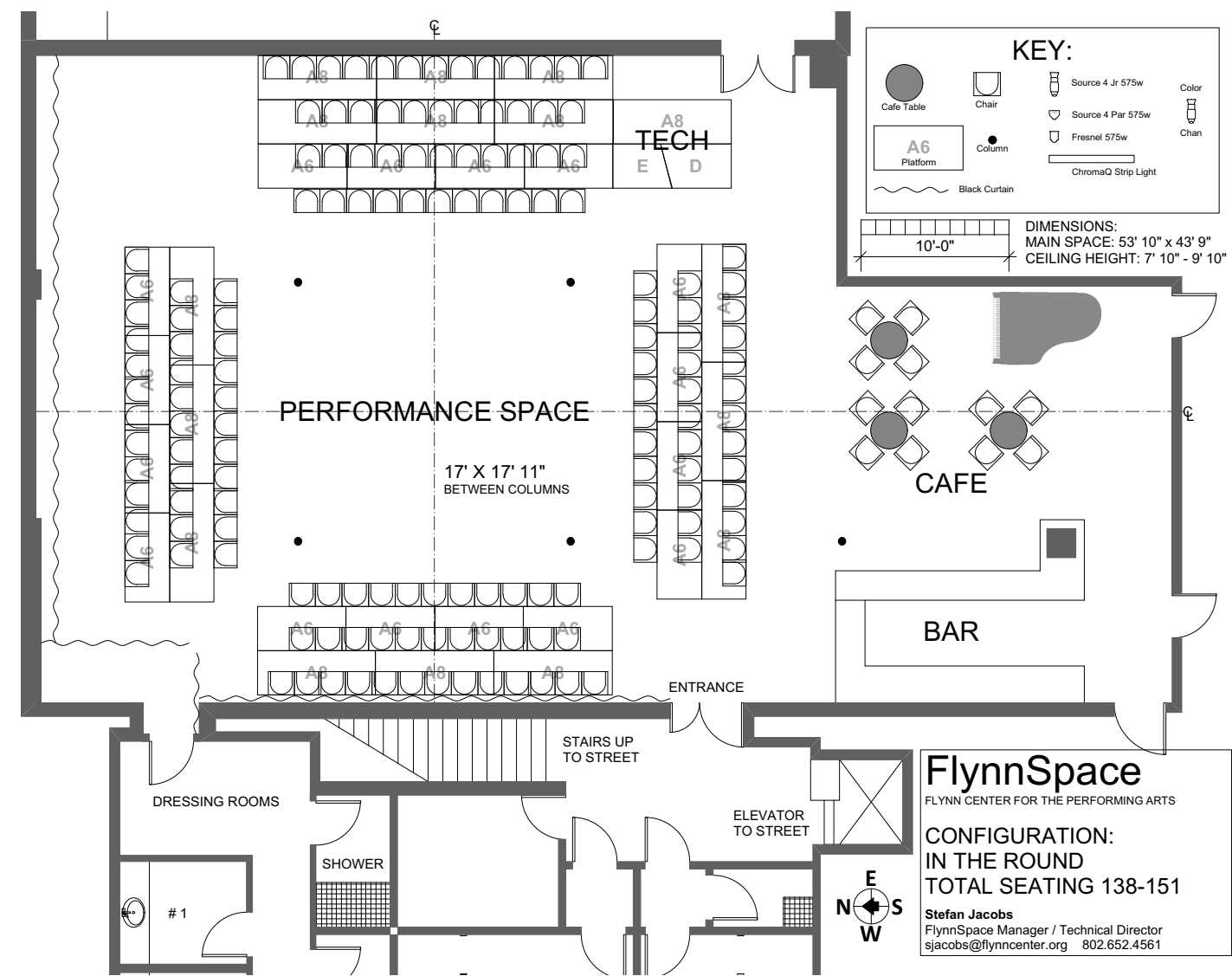

Jazz North Configuration

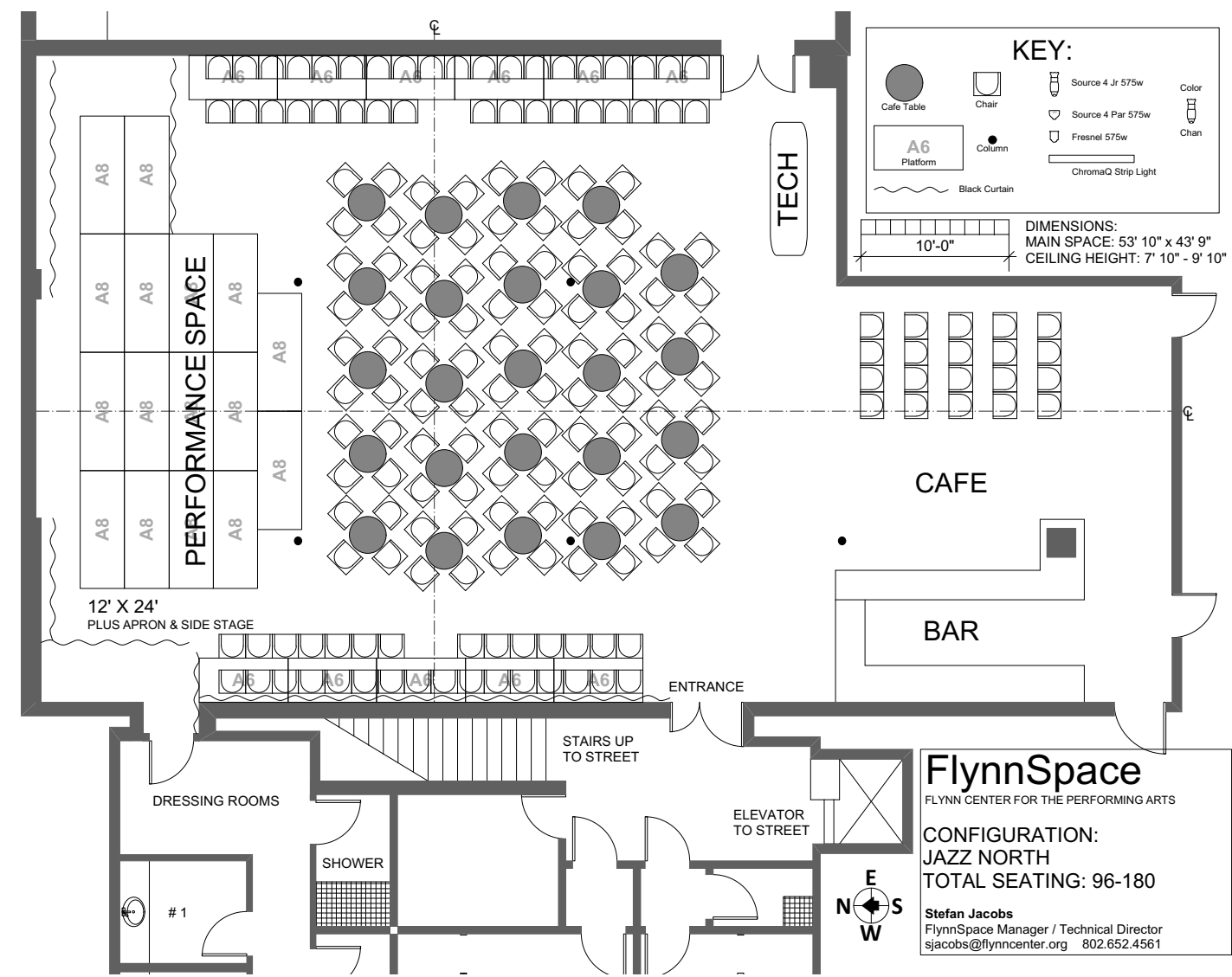

Grid Plan

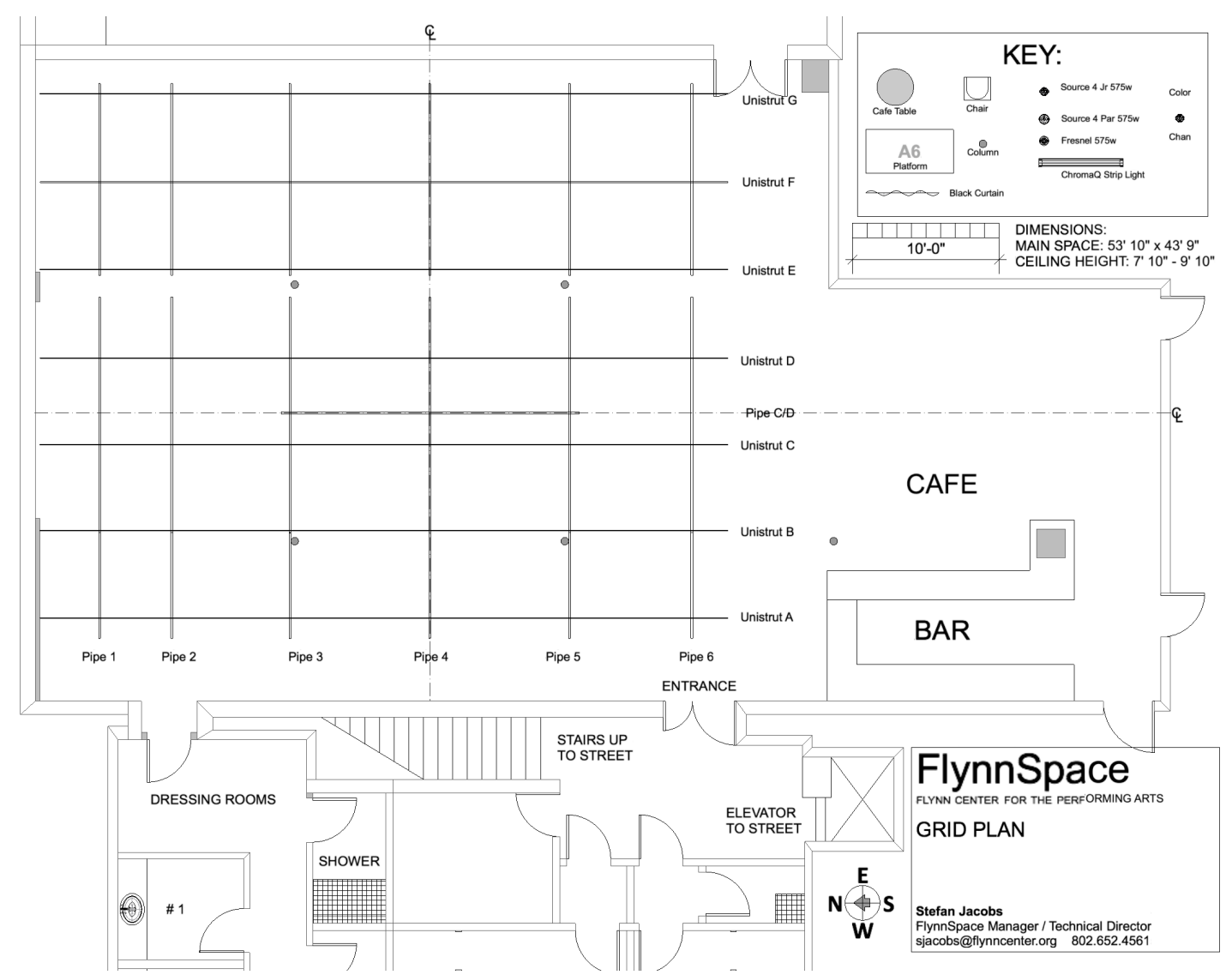

Circuit Plan

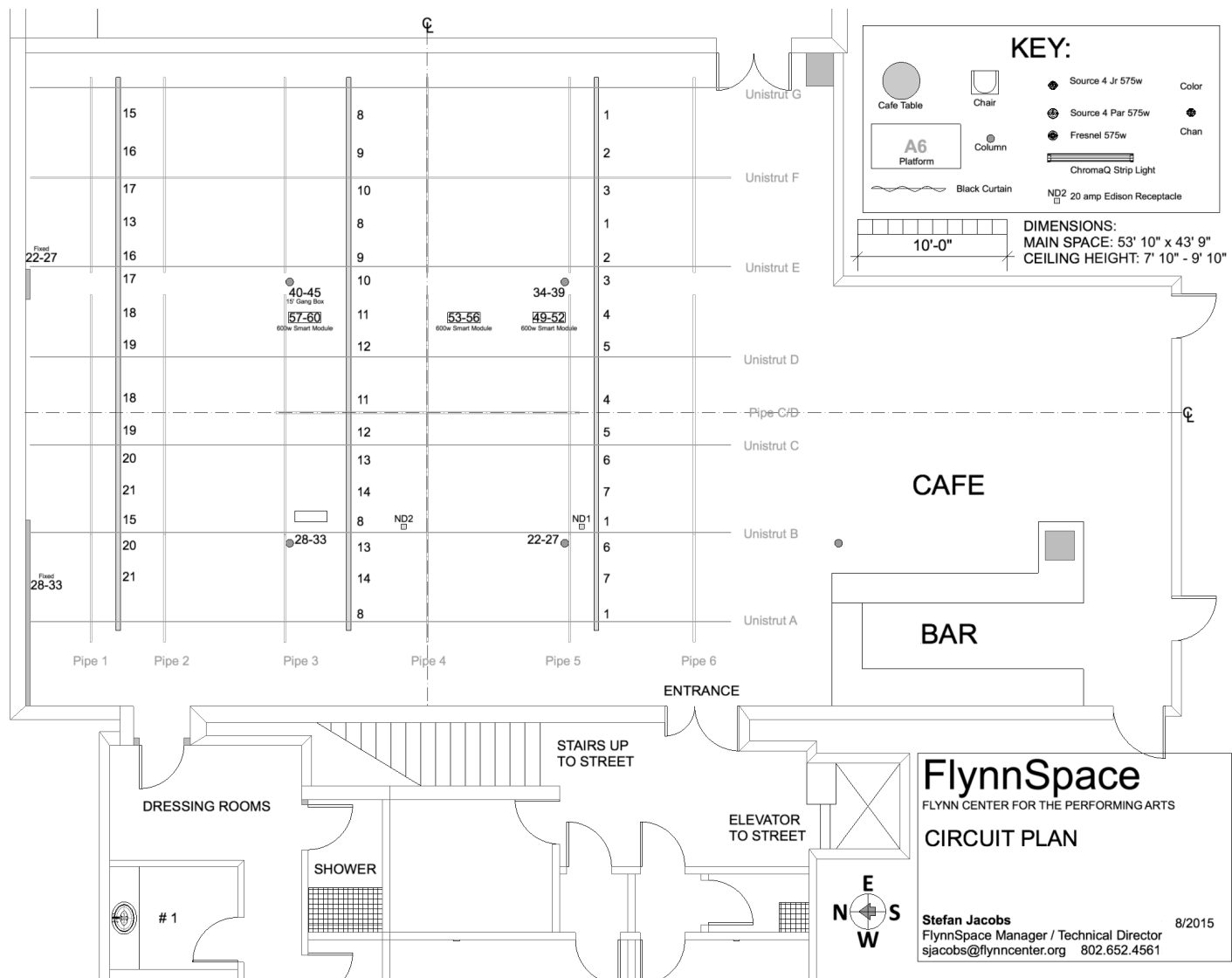



Configuration: Wide With Stage



FlynnSpace - Bar Cafe